

# **EZ Penpower Junior for Eee PC**

## **User Manual**

Version: V1.0

Edition: Released in April, 2008

# **Penpower Technology Ltd.,**

## **Software User License Agreement**

You are licensed to legally use this software program (“the Software”) by Penpower Technology Ltd (“Penpower”) under this license agreement (“The Agreement”). If you do not agree with any of the provisions in this Agreement, please do not install, copy or use the Software. By using the Software, you are deemed to fully understand and accept the provisions of this Agreement.

### **1. Intellectual Property**

All intellectual property rights in the Software, together with all information and documents included in the packaging for the Software (including but not limited to copyrights), are property of Penpower, and are protected by relevant laws and regulations.

### **2. License to Use**

You are authorized to use the Software on one (1) single computer only. You may not use the Software on any other machines other than the said single computer.

### **3. Authority to Copy**

The Software and all documents included with the Software, and copyright thereof, are property of Penpower. You are licensed to make one (1) copy of the Software for your personal backup purposes. All other acts of copying are strictly prohibited.

You may not sell, lease, disassemble, reverse engineer, copy, translate, adapt or derive the Software, or obtain the source code of the Software by any other means. You may not use the Software for any purposes other than those permitted under this Agreement.

### **4. Business Users**

If you need to install or use the Software on more than one (1) computer, please contact Penpower or our local distributor to purchase a license for the additional use.

### **5. Liability**

You agree to indemnify Penpower against all losses, costs, debts, settlement payments or other expenses (including but not limited to attorneys fees) arising from your breach of this Agreement, and you agree to compensate Penpower for all of the abovementioned damages.

## **6. No Warranty**

Effectiveness of a packaged software in handling information is closely related to its software and hardware environment. The Software is published following careful development and product testing by Penpower, but Penpower is not able to conduct tests based on all possible combinations of software and hardware environment. Therefore, Penpower is unable to promise nor warrant that there will be absolutely no risk of loss or damage of information, or any other kind of loss, during installation and/or execution of the Software. You must be fully aware of your risks in using the Software.

Penpower will provide you with the Software and support services in respect of the Software to the maximum extent permitted by law. However, Penpower does not warrant that the Software and information included in the package of the Software contain no defects or errors. Penpower is not liable for any indirect, special or incidental loss arising from the Software, including but not limited to loss of profits, damage to business reputation, cessation of work, hardware malfunction or damage, or any other commercial damage or loss arising from commercial use of the Software.

## **7. Limitation of Liability and Damages**

The maximum amount of compensation payable by Penpower, in respect of any damage incurred by you for any reason under this Agreement, is limited to the amount you have already paid to Penpower in respect of the Software.

Under no circumstances will Penpower be held liable for the possibility of loss, notwithstanding Penpower may be aware of the possibility of such loss.

## **8. Prohibition Against Sublicense**

You are prohibited to assign the license in respect of the Software granted to you under this Agreement, or to grant a sublicense to another person.

## **9. Jurisdiction**

With regards to any disputes arising from this Agreement, Penpower and you agree that the court having jurisdiction over the business location of Penpower will be the court in the first instance.

## **10. Miscellaneous**

In the event that any provision of this Agreement is found to be invalid at law, such invalidity will not affect the validity of any other provisions, or the legal enforceability of such other provisions.

In the event that the Software cannot be executed under conditions of normal use, due to any damage to the original disk/s, Penpower will replace the disk/s free of charge.

# Contents

<b>Chapter 1 Product Overview.....</b>	<b>1-1</b>
1.1 Introduction.....	1-1
1.2 Hardware Specification.....	1-2
<b>Chapter 2 Installation.....</b>	<b>2-1</b>
2.1 System Requirement.....	2-1
2.2 Installation.....	2-1
<b>Chapter 3 Hardware Operation.....</b>	<b>3-1</b>
3.1 Calibration.....	3-1
3.2 Handwriting Pad Hot Keys.....	3-2
<b>Chapter 4 User Guide.....</b>	<b>4-1</b>
4.1 Penpower Jr. Tool Bar.....	4-1
4.2 Start to write.....	4-2
4.2.1 Result Correction.....	4-2
4.2.2 Input Symbols.....	4-3
4.2.3 Related Phrase.....	4-3
4.2.4 Gesture.....	4-5
4.3 Setting.....	4-5
4.3.1 Recognition Setting.....	4-6
4.3.2 General Setting.....	4-7
4.3.3 Writing Setting.....	4-8

# Chapter 1 Product Overview

EZ Penpower Junior has a simple-to-use design and high recognition accuracy. Even if you are a first-timer to handwriting input, you can use it with easy.

## 1.1 Introduction

### **\* Traditional and Simplified Chinese recognition kernel**

Handwriting recognition input for Chinese, English, alphabet, numeric and symbol. The Unicode-based recognition kernel lets you input both Traditional and Simplified Chinese with ease.

### **\* Full screen free writing**

The accurate recognition technology provides a boundless handwriting environment, can be written in full screen and recognized directly in conjunction with most word processors and application software.

### **\* Other auxiliary functions**

Provide many useful functions, such as candidate words, related phrases, related words, common symbols, and hardware buttons...etc. to make input easier and faster.

## 1.2 Hardware Specification

- \* Dimensions: 110 X 113 X 18 mm
- \* Writing area: 55 X 42 mm
- \* Weight: 110g

## Chapter 2 Installation

### 2.1 System Requirement

- \* Hard Disk Space: 5MB
- \* Operation System: Traditional Chinese/Simplified Chinese/English Linux OS
- \* Apply Model: ASUS Eee PC
- \* Interface: USB port
- \* CD-ROM or download installation file

### 2.2 Installation

Insert the installation CD and run the installation program to install. When the installation process is done, you may find **Penpower Jr.** icon under **Work**. Connect EZ Penpower Jr. handwriting pad to your Eee PC USB port and click **Penpower Jr.** icon to begin using Penpower Jr. handwriting recognition system.

## Chapter 3 Hardware Operation

### 3.1 Calibration

After finishing installation, you should be able to hand write right away. If you found that the inking you wrote is not corresponded with screen, you need to calibrate your handwriting pad to remap the active area.

1. Please click **Settings**  from the Penpower Jr. tool bar, and select **Calibration** under the **General** tag to run Calibration.

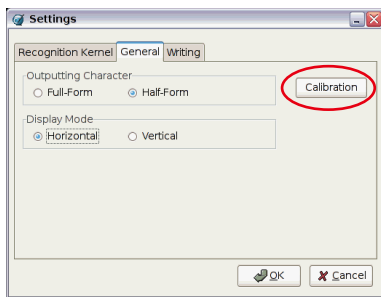

2. Please click on the four corners of handwriting pad starting from top-left in counterclockwise direction. After calibration, the new configuration would take effect immediately. You do not need reboot or reload Penpower Jr. handwriting recognition system.

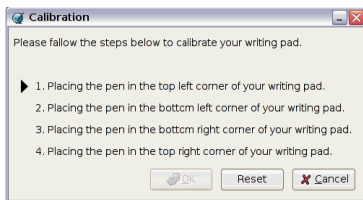





## 3.2 Handwriting Pad Hot Keys



### **There are three buttons on the handwriting pad:**

The button on the bottom: the writing and mouse mode switch button.

Top-left button: It can be used to select candidate words in the writing mode. It also can be used as the left click on the mouse in the mouse mode.

Top-right button: It can be used to input and select symbols such as , ° , ~ , ; , ! , ? in the writing mode. It also can be used as the right click on the mouse in the mouse mode.





Writing and Mouse mode switch: Switch the handwriting pad to Writing or Mouse mode. It is the same as the the button on the bottom of writing pad.

Settings: provide settings of selecting recognition kernels, outputting character, and inking settings etc.

User Manual: Provide user manual.

## 4.2 Start to write

Open an editor application and position your cursor on the desired inputting place, then starting to write a word on writing pad. The recognized result will be transferred directly to the desired application.

### 4.2.1 Result Correction

After recognizing, the tool bar shows five candidate words. If the recognition result is not correct, click the candidate word if the correct word is there. You may press the left button of the writing pad once each time, the latest recognized result would be replaced with the next candidate word. It lets you correct the result quickly without switching to mouse mode.

e.g. 『技』 is wrongly recognized as 『投』, click the candidate word if the correct word is there. You will see the wrong result 『投』 is already updated as 『技』.



## 4.2.2 Input Symbols

When writing Chinese, you may need to input symbols. Besides writing symbols, you can press top-right button on the writing pad to input the most common-used symbols such as ‘, °, \, ;, :, !, ?, quickly click again to switch the symbol. You can also click the symbol table button on the tool bar with the mouse to select a symbol.



*Tip: When you open the symbol table but do not need to input any symbol, you may simply click on other place to cancel it.*

## 4.2.3 Related Phrase

### \* Input words by Related Phrase

Press the Related Phrase button on the tool bar to open the Related Phrase. Then write down one word e.g. 『科』, you can see six phrases beginning with this word 『科』 be listed on the phrase area. You can change to mouse to click the phrase that you want to send it into the caret. e.g. 『科學中心』.

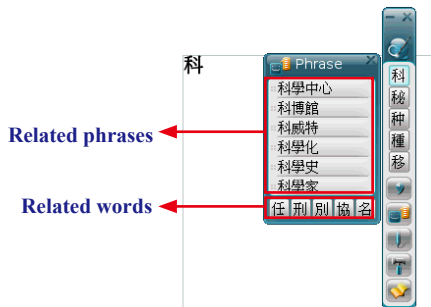

科學中心

#### **\* Input related word**

The Related Phrase window also show related words on the bottom of Related Phrase Window. When write down one word e.g. 『科』, you can see five related words be listed on the related words area. You can change to mouse mode to click the related word that you want to send it into the caret. e.g. 『協』.

科協

## 4.2.4 Gesture

Penpower Jr. handwriting system supports four standard inking gesture. You can handwriting these gestures to simulate keyboard input.

1. Delete: simulate DELETE key.



2. Backspace: simulate BACKSPACE key.



3. Enter: simulate ENTER key.

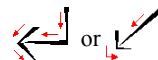

4. Space: simulate SPACE key.



## 4.3 Setting

Click on the **Setting** button from the tool bar to open the settings window. You can configure the recognition kernel, output format or writing inking here.

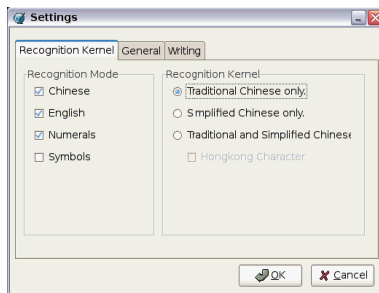



### 4.3.1 Recognition Setting

#### \* **Recognition Mode:**

The recognition mode of Chinese, English, Numeral and Symbol could be turned on/off individually. You could turn on several modes at the same time. Recommend according with the input language to turn on the recognition kernel for higher accuracy.

#### \* **Recognition:**

1. Traditional Chinese: All the results are recognized in traditional words.
2. Simplified character: All the results are recognized in simplified words.
3. Traditional and Simplified Chinese: You will get traditional words while using traditional writing, and get simplified words while using simplified writing.

e.g. Handwrite one traditional Chinese word 『書』, the recognition result will be traditional Chinese, and then handwrite one simplified Chinese word 『写』, the recognition result will be simplified Chinese.

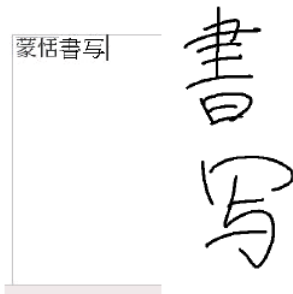

4. Hongkong Character: If you need to recognize Hongkong Character, you can select **Traditional and Simplified Chinese** to select **Hongkong Character**.

### 4.3.2 General Setting

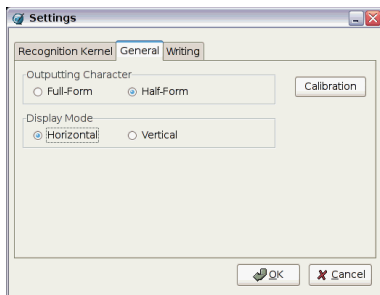

#### **\* Half Form/Full Form:**

To decide the output character of the alphanumeric recognition results will be in one-byte ASCII code (half form) or double-bytes code (full form).

#### **\* Calibration**

Click the **Calibration** button to calibrate the handwriting pad. Please refer to 3.1 Calibration.

#### **\* Display Mode**

The setting of the tool bar display as horizontal or vertical.

**Vertical**





### 4.3.3 Writing Setting

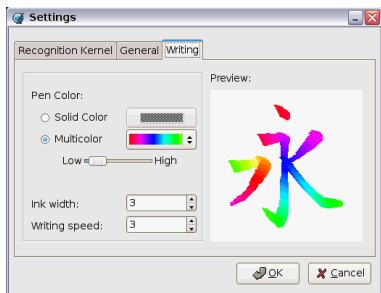

#### **\* Ink color :**

Change the color of inking. You can adjust the smoothness of color degree for Multicolor option.

#### **\* Ink width :**

Change the thickness of inking.

#### **\* Speed :**

There are several levels of writing speed you can set. After you stop writing, the less the relative value is, the shorter the timeout waiting for recognition is.

#### **\* Preview:**

The Preview area shows the effect of the settings.

Click OK to close setting window.

# **EZ Penpower Junior for Eee PC V1.0 User Manual**

Penpower Technology LTD.,

Edition: Released in April, 2008